



EASTON ATTACK TT HANDLEBAR

Congratulations on your purchase of an Easton Attack TT Handlebar. To ensure the best performance and longest service life from your handlebar, please read and carefully follow these installation instructions.

CAUTION!

A qualified bicycle mechanic using appropriate professional tools should install all Easton products. **Easton assumes no liability for products which are improperly installed.**

⚠ WARNING!

Failure to follow these instructions can result in component failure. Component failure can lead to loss of control of the bicycle and result in serious personal injury or death.

⚠ WARNING!

Easton Attack TT Handlebars can require riding positions that are new or different to many riders. We recommend that you practice using these Handlebars in a low traffic area to become accustomed to any changes in the steering or handling characteristics of the bike. Please exercise caution when using these types of handlebars for the first time. Also, make sure that you continue to look forward when riding and do not look down towards the ground.

1. Before you start

NOTE: Attack TT Handlebars require a stem with a 31.8 mm handlebar clamp and a removable or hinged faceplate. Stem faceplate and stem body at the handlebar interface cannot be wider than 45 mm.

- Confirm that your stem has a 31.8 mm clamp diameter.

Attack TT Handlebars are designed to fit stems with compatible 31.8 mm clamp diameters. Incorrect mating of the handlebar and stem can cause handlebar or stem failure.

- Remove the old handlebar and inspect the stem's handlebar clamp for burrs or sharp edges. Remove any burrs or sharp edges with 320/400 grit sandpaper.

Sharp edges can create stress risers on the handlebar, which could result in handlebar failure.

2. Installation of the Handlebar

CAUTION!

When installing Easton components in conjunction with another manufacturer's components, always follow that manufacturer's instructions for proper installation procedure. EASTON ASSUMES NO LIABILITY FOR DAMAGE CAUSED BY INSTALLING OTHER MANUFACTURERS PRODUCTS.

- Remove and lightly grease all bolt threads.
- Thoroughly clean the clamping surfaces of both the handlebar and the stem with alcohol, and alloy to dry. Apply carbon friction paste to the clamping surfaces.
- Install the Easton Attack TT Handlebar in the stem (Figure 1), position it as desired, and secure it into position according to the stem manufacturer's instructions.

3. Pad Supports and Pads

- Pad height can be increased with the included riser kit. If a pad riser kit is used, position the riser block under the pad holder and install with the included longer fasteners. Pad supports can be adjusted forward and aft by swapping the right and left supports.
- Adjust pad supports to desired position and tighten fasteners to 25 to 35 in-lbs (3 to 4 Nm).

- Attach pads by removing the paper backing from the adhesive, position the adhesive, and stick the pad Velcro onto the pad support.

⚠ WARNING!

Whenever an Attack TT handlebar equipped bike is placed on a roof rack or mounted externally on a vehicle for transport, remove the armrest pads. Easton Warranty does not cover pads lost during transport.

4. Fitting Extensions

Attack TT—Adjustable:

CAUTION!

When assembling the extension in the adjuster, the collet slots must line up with the alignment pins in the socket (Figure 2). Failure to line up the collet slots with the pins could result in damage.

- Assemble the extension into the adjuster as shown (Figure 3).
- Regardless of extension length, cut or uncut, the extensions must be inserted the required 48 mm (Figure 4). Follow the carbon cutting instructions posted on the <www.eastonbike.com> web site.

If the extensions are inserted completely and a shorter reach is desired for rider preference, the rear ends of the adjustable aero extensions can be trimmed up to a maximum of 90 mm.

- Position the extensions in the desired position and tighten with supplied Easton tool (Figure 5). Tighten the nuts with the tool until the extensions are secure. Check the security of both extensions to confirm they do not move, rock, or twist in the adjusters.

Attack TT—Non-Adjustable:

The forward ends of the aero extensions can be trimmed up to 2 in. (50 mm) for rider preference. Follow the carbon cutting instructions posted on the <www.eastonbike.com> web site.

5. Shifter Installation

- The Attack TT extensions are designed to accept Shimano, Campagnolo, and SRAM bar end shifters.
- The Attack TT bars are designed for internal routing of shifter cables. First run the housing through the ports; remembering to allow enough slack for the handlebars to turn 90° in both directions; trim the housing to the required length, and then install the bar end shifters following the shifter manufacturer's instructions.

- Wrap the ends of the aero extension with handlebar tape as desired.

6. Brake Lever Installation

- The Attack TT bar is compatible with both internal and external clamp brake levers.
- The outer handles, where brake levers mount, must not be trimmed or modified in any way.
- The Attack TT bars are designed for internal routing of brake cables (Figure 6). First run the housing through the ports; remembering to allow enough slack for the handlebars to turn 90 degrees in both directions; trim the housing to the required length, and then install the brake levers following the lever manufacturer's instructions.

Attack—Adjustable ONLY:

The Attack—Adjustable bar has two holes on the back of the bar for the right brake housing exit (Figure 6, D+E). Choose the hole that best suits your frame design and cable routing.

- Wrap the ends of the outer handles with handlebar tape as desired.

Note: To ease brake housing installation, use brake cable only and feed backward through bar from brake housing OUT to brake housing IN. Then feed brake housing over cable and through bar. Then remove brake cable and complete brake lever installation with cable in correct direction.

⚠ WARNING: FOLLOW THE BRAKE MANUFACTURER'S ASSEMBLY INSTRUCTIONS AND SPECIFICATIONS. POOR BRAKE PERFORMANCE AND/OR FAILURE CAN LEAD TO LOSS OF CONTROL, WHICH CAN RESULT IN SERIOUS INJURY OR DEATH.

7. Maintenance

Attack TT Handlebars must be maintained and inspected closely. In particular:

- Inspect for dents, bends, deep scratches, cracks or gouges before each ride. If any are visible, do not use the bicycle until the handlebar has been replaced. Handlebars may be severely weakened even if no damage is visible. After a major impact or accident, even if no damage is visible, have a dealer inspect the handlebar before using the bicycle. Do not attempt to straighten a bent handlebar. It must be replaced.
- Before clamping any item to the handlebar, make sure the clamp is free of any burrs or sharp edges. Do not use a rotating motion to mount any clamped item on the bars. Scratches can cause stress concentrations that can significantly shorten the life of the handlebar.
- Replace your handlebars periodically. Consult your dealer as to the appropriate frequency of replacement. Replace a scratched or damaged handlebar immediately. Destroy any handlebar which you have replaced for safety reasons.

WARRANTY

Easton products are warranted to be free of defects in materials and workmanship. Easton carbon fiber handlebars are warranted for lifetime. Warranty is for the original owner only and proof of purchase is required. This warranty is in lieu of all other warranties. ANY IMPLIED WARRANTIES OF FITNESS FOR A PARTICULAR PURPOSE OR WARRANTIES OF MERCHANTABILITY ARE LIMITED TO THE DURATION OF THE EXPRESSED WARRANTY. Depending on individual state laws, the above exclusion may not apply to you. This warranty gives you specific rights. You may have other legal rights depending on the state in which you reside.

Please consult the *Contact Us* page of the Easton web site <www.eastonbike.com> for warranty contact information. Select *U.S. Dealers* or *International Distributors* depending on your location.

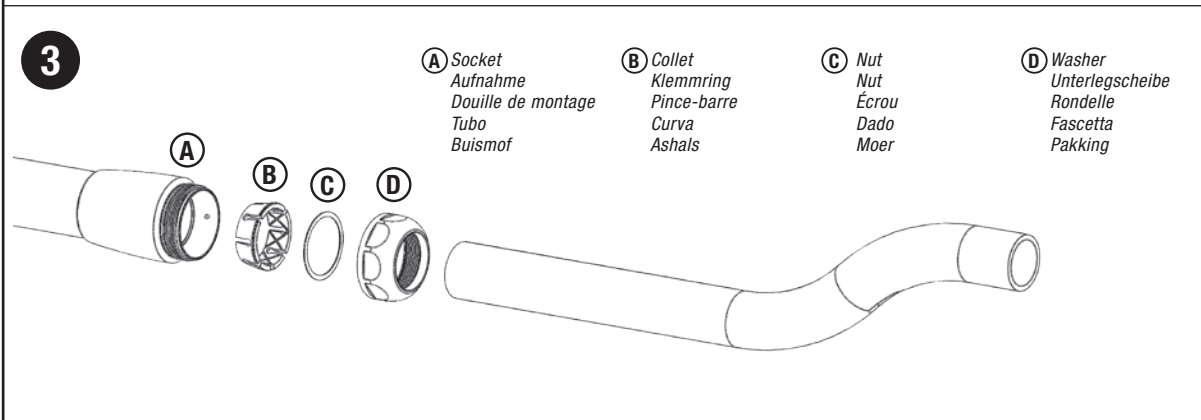
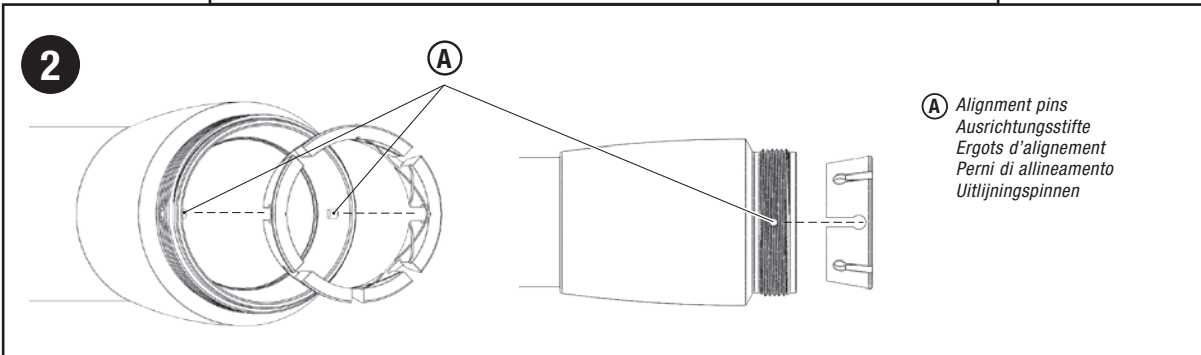
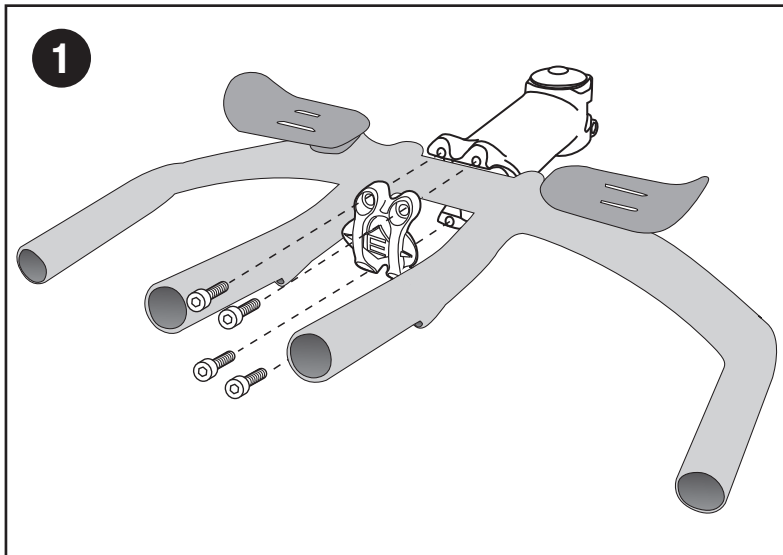



4

A Maximum cut allowed (90 mm)
Maximal zulässige Kürzung (90 mm)
Coupe maximale autorisée (90 mm)
Taglio massimo consentito (90 mm)
Maximum toegelaten inkorting (90 mm)

B Uncut
Ungekürzt
Non coupée
Non tagliato
Ongesneden

C End of extension
Ende des Aufsatzes
Extrémité de l'extension
Estremità dell'estensione
Uiteinde van handgreep

D Minimum insertion (48 mm)
Mindesteinführtiefe (48 mm)
Insertion minimale (48 mm)
Inserimento minimo (48 mm)
Minimale invoeging (48 mm)

5

6

Front housing routings
Zugverlegung vorn
Acheminements de gaine (avant)
Instradamenti dell'alloggiamento anteriore
Voorste kabeldoorvoer

Rear housing routings
Zugverlegung hinten
Acheminements de gaine (arrière)
Instradamenti dell'alloggiamento posteriore
Achterste kabeldoorvoer

A Shifter - IN
Schalthebel – EINTRITT
Dérailleur – ENTRÉE
Cambio – INGRESSO
Vernelling – IN

B Brake - IN
Bremse – EINTRITT
Frein – ENTRÉE
Freno – INGRESSO
Rem – IN

C Brake - OUT
Bremse – AUSTRITT
Frein – SORTIE
Freno – USCITA
Rem – UIT

D Shifter - OUT
Schalthebel – AUSTRITT
Dérailleur – SORTIE
Cambio – USCITA
Vernelling – UIT

E Brake - OUT Alternate (Adjustable only)
Bremse – Alternativer AUSTRITT (nur einstellbare Ausführung)
Frein – SORTIE en alternative (uniquement modèle réglable)
Freno – USCITA alternativa (solo Regolabile)
Rem – UIT Afwisselend (Alleen voor Regelbaar)

BOTTOM VIEW
SICHT VON UNTEN
VUE DU BAS
VISTA INFERIORE
ONDERAANZICHT

© 2009, Easton Sports, Inc.

www.eastonbike.com