

Easton DeltaForce Handlebar

Congratulations on your purchase of an Easton DeltaForce handlebar. To ensure the best performance and longest service life from your handlebar, please read and carefully follow these installation instructions.

CAUTION!

A qualified bicycle mechanic using appropriate professional tools should install all Easton products. Easton assumes no liability for products which are improperly installed.

WARNING!

Failure to follow these instructions can result in component failure. Component failure can lead to loss of control of the bicycle and result in serious personal injury or death.

WARNING!

Easton DeltaForce handlebars can require riding positions that are new or different to many riders. We recommend you practice using these handlebars in a low traffic area to become accustomed to any changes in the steering or handling characteristics of the bike. Please exercise caution when using these types of handlebars for the first time. Also, make sure that you continue to look forward when riding and do not look down towards the ground.

1. Before you start

NOTE: DeltaForce handlebars require a stem with a removable or hinged face plate (see Figure 1). Stem face plate and stem body at handlebar interface cannot be wider than 45 mm.

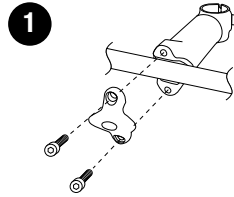

- Verify that the following parts have been supplied in the box: the DeltaForce bar and a two-piece adapter shim for use with 31.8 mm stems.

- Confirm that the DeltaForce handlebar clamp surface diameter is the same as the stem's handlebar clamp diameter. Easton DeltaForce handlebars can only be mounted in stems with a 26.0 mm clamp diameter (or 31.8 mm diameter with supplied adapter shim).

DeltaForce handlebars are designed to fit stems with compatible clamp diameters. Incorrect mating of the handlebar and stem can cause handlebar or stem failure.

- Remove the old handlebar and inspect the stem's handlebar clamp for burrs or sharp edges. Remove any burrs or sharp edges with 320/400 grit sandpaper.

Sharp edges can create stress risers on the handlebar, which could result in handlebar failure.

2. Installation of the handlebar

CAUTION!

When installing Easton components in conjunction with another manufacturer's components, always follow that manufacturer's instructions for proper installation procedure. EASTON ASSUMES NO LIABILITY FOR DAMAGE CAUSED BY INSTALLING OTHER MANUFACTURERS PRODUCTS.

- Thoroughly clean the clamping surfaces of both the handlebar and the stem. Do not lubricate the clamping surfaces.

- Install the Easton DeltaForce handlebar in the stem, position it as desired, and secure it into position according to the stem manufacturer's instructions.

3. Brake Lever Installation

CAUTION!

Easton DeltaForce handlebars are compatible with both inside (plug) mounted or external clamp mounted brake levers. Carefully follow the brake manufacturer's installation instructions, as the DeltaForce handlebar can be damaged from improper installation. EASTON ASSUMES NO LIABILITY FOR DAMAGE CAUSED BY IMPROPERLY INSTALLED BRAKE LEVERS.

CAUTION!

The ends of the DeltaForce can be cut down up to 1 cm to suit rider preference. If this is done the cut must be perpendicular to the end of the bar. Use a cutting guide and a sharp, fine tooth hack saw blade. Wrap masking tape around cut area to minimize carbon fiber fraying. Clean and deburr after cut using 320/400 grit sand paper. Always make sure that brake levers have enough cable pull after any modifications.

- Trim brake cable housing to length. Make sure to leave enough slack for handlebars to turn without binding the cables.
- Insert brake cable housing through grommet on bottom of airfoil (Figure 2) until it is flush with end of handlebar for inside-diameter-pull brake levers (Syntace, etc.) (Figure 3) or through slot on bottom for outside-diameter-pull brake levers (Dia Compe, Tektro, Shimano, etc.) (Figure 4).
- Insert brake cable into cable housing at end of handlebar and feed through cable housing. Secure end of brake cable to brake lever and attach brake lever to DeltaForce handlebar following brake lever manufacturer's instructions.
- Attach other end of brake cable to brake caliper following brake manufacturer's instructions. Test brakes before riding to make sure brakes function correctly and the location of the brake lever provides sufficient cable pull.
- Repeat for other lever.
- Tape Handlebar as desired.

4. Clip-On Installation

CAUTION!

Easton DeltaForce handlebars are only compatible with Easton manufactured Clip-On Handlebars. EASTON ASSUMES NO LIABILITY FOR DAMAGE CAUSED BY INSTALLATION OF OTHER MANUFACTURER'S CLIP-ON HANDLEBAR.

- Attach Easton clip-on to straight section of DeltaForce on both sides of the stem. Make sure that the clamp only rests on straight section and does not interfere with the radius at the beginning of the wing section. For correct clip-on installation and setup follow instructions supplied with the clip-on.

5. Maintenance

DeltaForce handlebars must be maintained and inspected closely. In particular:

- Inspect for dents, bends, deep scratches, cracks or gouges before each ride. If any are visible, do not use the bicycle until the handlebar has been replaced. Handlebars may be severely weakened even if no damage is visible. After a major impact or accident, even if no damage is visible, have a dealer inspect the handlebar before using the bicycle. Do not attempt to straighten a bent handlebar. It must be replaced.
- Before clamping any item to the handlebar, make sure the clamp is free of any burrs or sharp edges. Do not use a rotating motion to mount any clamped item on the bar. Scratches can cause stress concentrations that can significantly shorten the life of the handlebar.
- Replace your handlebars periodically. Consult your dealer as to the appropriate frequency of replacement. Replace a scratched or damaged handlebar immediately. Destroy any handlebar which you have replaced for safety reasons.

WARRANTY

Easton products are warranted to be free of defects in materials and workmanship. Easton carbon-fiber handlebars are warranted for lifetime. Warranty is for the original owner only and proof of purchase is required. This warranty is in lieu of all other warranties. ANY IMPLIED WARRANTIES OF FITNESS FOR A PARTICULAR PURPOSE OR WARRANTIES OF MERCHANTABILITY ARE LIMITED TO THE DURATION OF THE EXPRESSED WARRANTY. Depending on individual state laws, the above exclusion may not apply to you. This warranty gives you specific rights. You may have other legal rights depending on the state in which you reside.

Please consult the Contact Us page of the Easton web site <www.eastonbike.com> for warranty contact information. Select U.S. Dealers or International Distributors depending on your location.

