



Technical Manual

R2 Front Hub Disassembly / Assembly

Page 2 of 2

Rev A

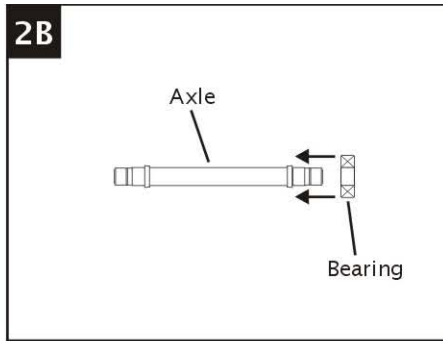

Slip a bearing onto the Axle end.

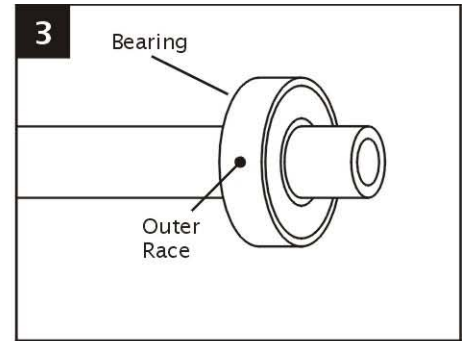

Apply a thin coat of Loctite to the outer race of the bearing.

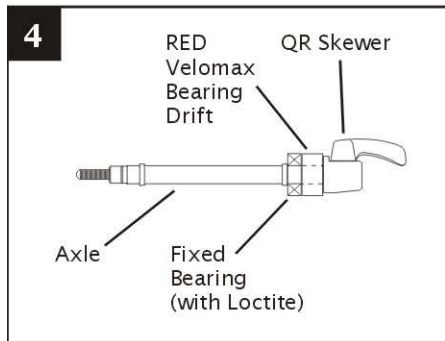

Slip the RED Velomax Bearing Drift against the bearing. Insert a Quick Release Skewer through the Axle.

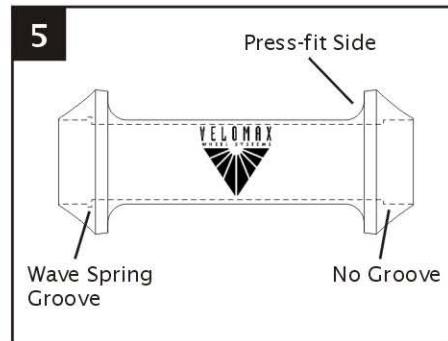

One side of the Hub Shell has a Wave Spring groove, the other does not. The side without the groove is the press-fit side.

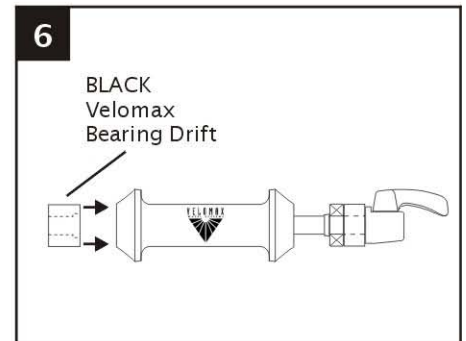

Insert the BLACK Velomax Bearing Drift into the Wave Spring side of the Hub Shell. **IMPORTANT** - the recess in the drift must be facing IN. Insert the Axle/Bearing assy. Into the press-fit side of the Hub Shell.

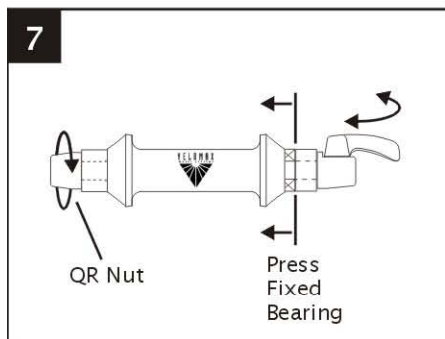

With the QR Lever open, screw on the QR Nut until tight. Press the Fixed Bearing by closing the QR Lever. Open the Lever and re-tighten the Nut, then close the Lever again. Repeat until Bearing is FULLY BOTTOMED.

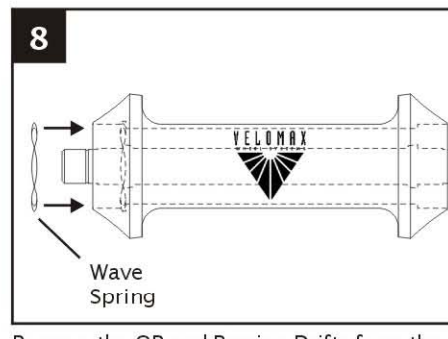

Remove the QR and Bearing Drifts from the Hub. Wipe away any excess Loctite. Slip the Wave Spring into the groove in the slip-fit side of the Hub Shell. Make sure it snaps FULLY into its groove. Note - The Wave Spring is intentionally cut!

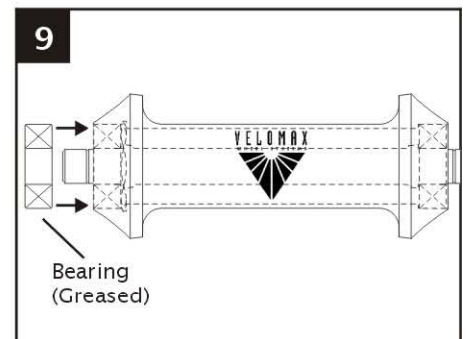

Apply a thin film of waterproof grease to the outer race of the remaining Bearing. Slip the Bearing into the slip-fit side of the Hub Shell by hand.

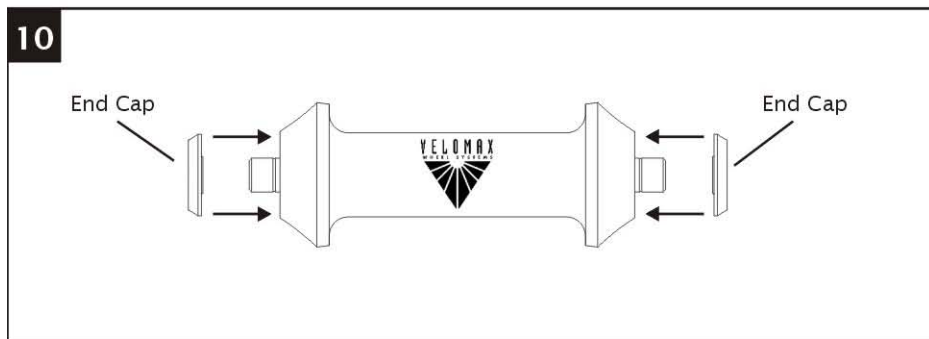

Install the End Caps onto the Axle ends. *Hint* - slip the End Caps partially on either end of the Axle. Grasping both Caps, twist them in opposite directions while applying inward pressure. *Note* - The End Caps come with rubber O-rings already installed. If the O-rings are missing, they can be replaced.

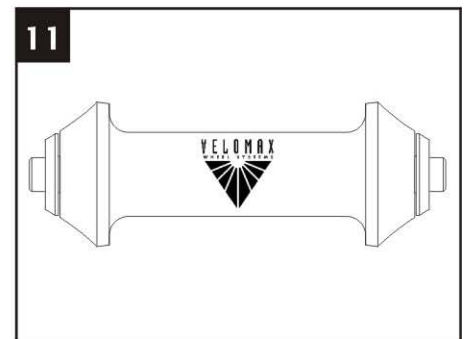

Completed R2 Front Hub. ASSEMBLY is now completed.