

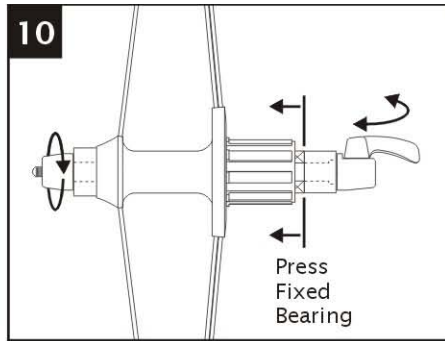

Technical Manual

R1 and R2 Rear Hub Disassembly / Assembly



With the QR lever open, screw on the QR nut until tight. Press the Fixed Bearing by closing the QR lever. Open the lever and re-tighten the nut, then close the lever again. Repeat until Bearing is FULLY BOTTOMED.

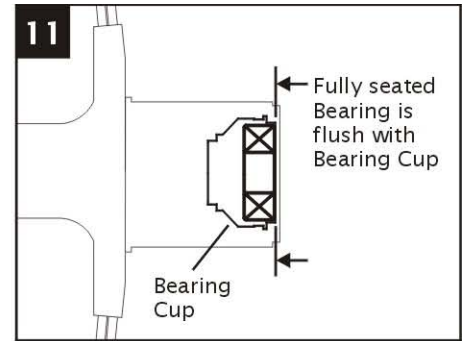

The Fixed Bearing is fully seated when it is flush with the Bearing Cup. Remove the QR and Drifts. Check to make sure the Fixed Bearing is FULLY SEATED. Wipe clean any excess Loctite.

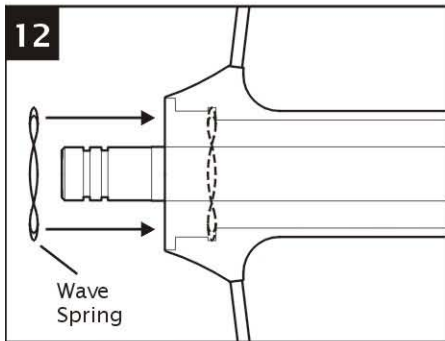

Slip the Wave Spring into the groove inside the non-drive side of the Hub Shell. Make sure it snaps all the way around into its groove. *Note* - the Wave Spring is intentionally cut!

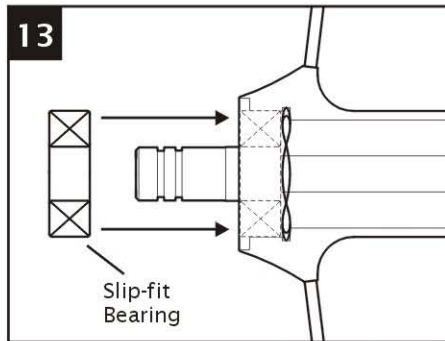

Apply a thin film of grease to the outer race of the remaining bearing. Slip the bearing into the bore on the non-drive side of the Hub Shell.

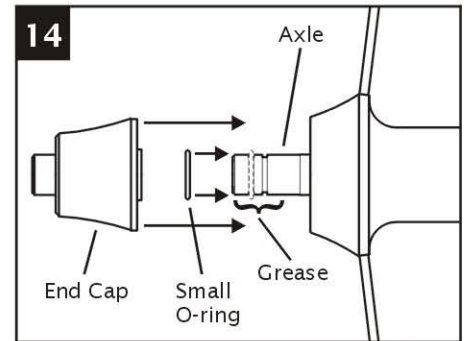

Slip the Small O-ring onto the end of the Axle. Apply a thin film of grease to the end of the Axle. Slip the End Cap onto the Axle. **DO NOT FORCE THE END CAP ON.**

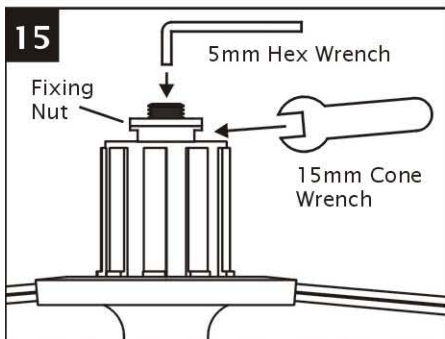

Apply a thin film of grease to the Axle threads. Using a 5mm hex and 15mm cone wrench, tighten the Fixing Nut onto the Axle. *Note* - the Fixing Nut is not used for adjustment. **DO NOT OVER-TIGHTEN.**

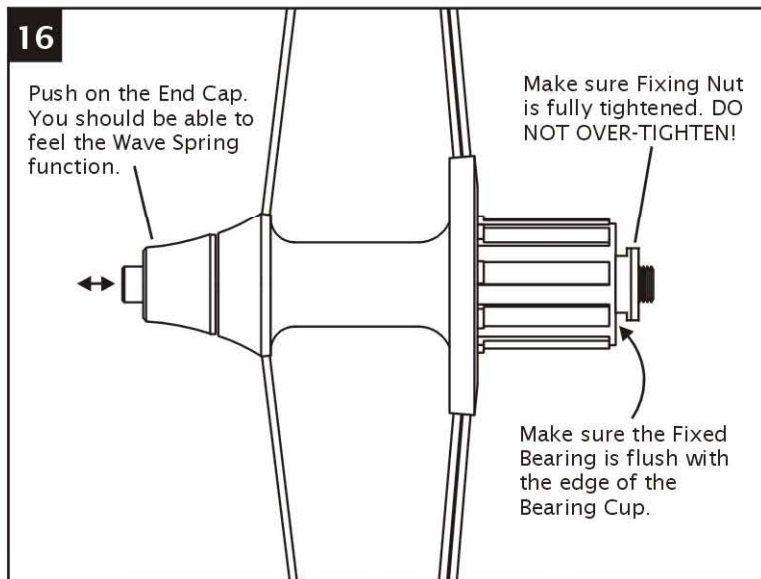

ASSEMBLY is now completed. To make sure that everything was done right, check the following:

1. Make sure that the Fixing Nut is fully tightened. **DO NOT OVER-TIGHTEN.**
2. Push on the end of the End Cap. You should be able to feel the Wave Spring function.
3. Make sure the Fixed Bearing is flush with the edge of the Bearing Cup.
4. Clamp the wheel into the bicycle frame dropout. Spin the wheel with the QR open. As the wheel is spinning, tighten the QR. If the wheel slows down quickly, then the bearings are installed incorrectly.