

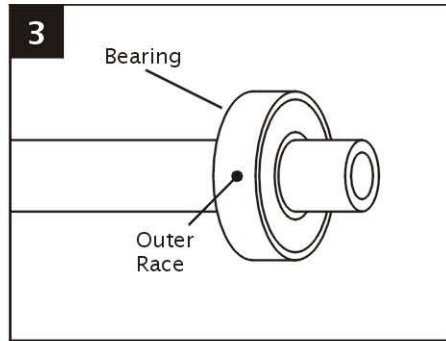



# Technical Manual

## R1 Front Hub Disassembly / Assembly



Apply a thin coat of Loctite 638 (or alternate) to the outer race of the bearing.

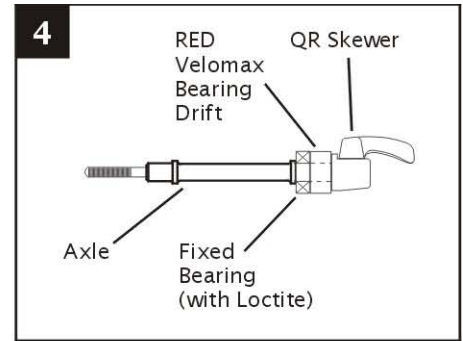

Slip the RED Velomax Bearing Drift against the bearing. Insert a front quick release skewer through the Axle.

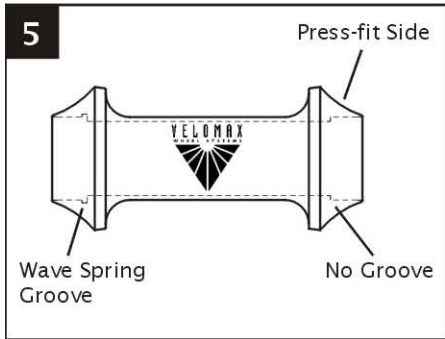

One side of the Hub Shell has a Wave Spring groove, the other does not. The side without the groove is the press-fit side.

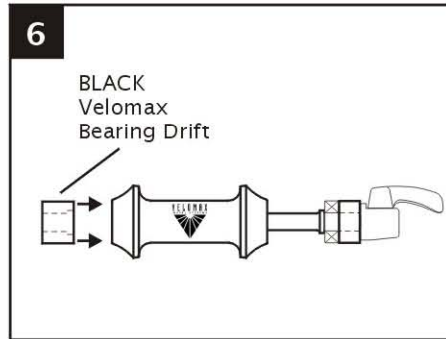

Insert the BLACK Velomax Bearing Drift into the Wave Spring side of the Hub Shell. **IMPORTANT - the recess in the drift must be facing IN.** Insert the Axle/Bearing assy. into the press-fit side of the Hub Shell.

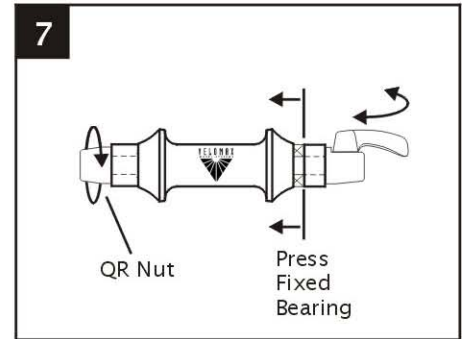

With the QR Lever open, screw on the QR Nut until tight. Press the Fixed Bearing by closing the QR Lever. Open the Lever and re-tighten the Nut, then close the Lever again. Repeat until Bearing is FULLY BOTTOMED.

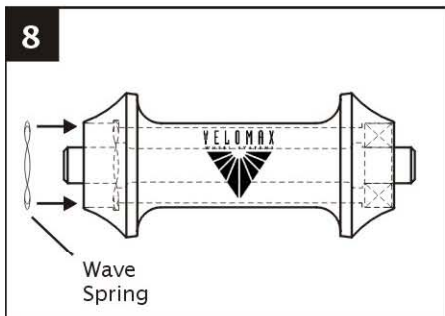

Remove the QR and Bearing Drifts from the Hub. Wipe away any excess Loctite. Slip the Wave Spring into the groove in the slip-fit side of the Hub Shell. Make sure it snaps FULLY into its groove. Note - The Wave Spring is intentionally cut!

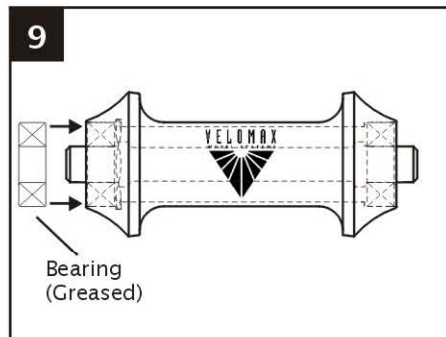

Apply a thin film of waterproof grease to the outer race of the remaining Bearing. Slip the Bearing into the slip-fit side of the Hub Shell by hand.

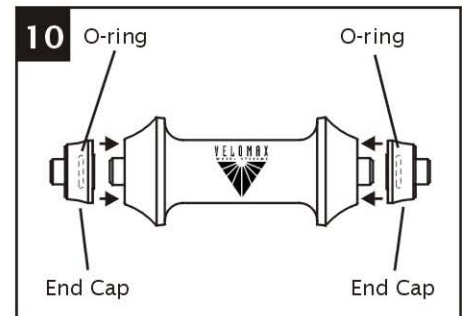

Look inside the End Cap to make sure there is an O-ring installed. If disassembled or missing, use a ball point pen or tweezers to help you install the O-ring. *Note* - End Caps are supplied with O-rings installed. Slip both End Caps onto the ends of the Axle.

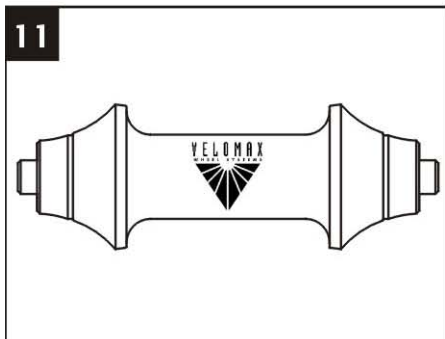

Completed R1 Front Hub.