

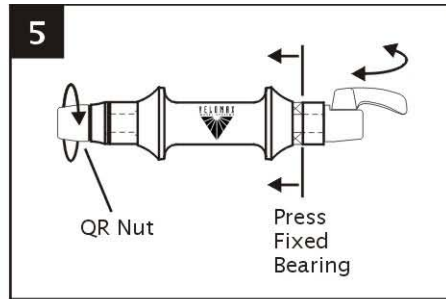

Technical Manual

Circuit Front Hub Disassembly / Assembly



With the QR lever open, screw on the QR nut until tight. Press the Bearing into the Hub Shell by closing the QR lever. Open the lever and re-tighten the QR nut, then close the lever again. Repeat until Bearing is FULLY BOTTOMED. Remove skewer, Drifts and End Cap from Hub.

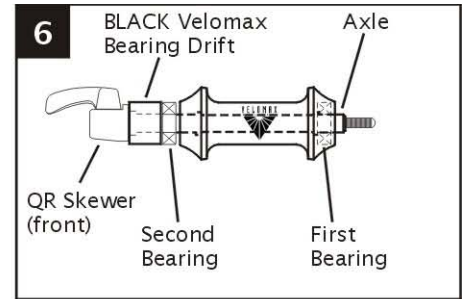

With the Axle still in the Hub, slip the remaining Bearing onto the Axle and line up in the bearing bore. Place the BLACK Velomax Bearing Drift against the Bearing. IMPORTANT - The recess in the drift must be facing OUT. Slip a QR skewer through the Axle.

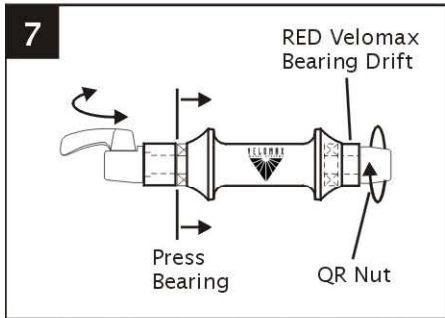

Place the RED Velomax Bearing Drift onto the other end of the Axle. With the QR lever open, tighten the QR nut onto the QR skewer. Press the Bearing into the Hub until it feels like the Bearing is bottomed. *Note* - the Bearing is not fully pressed yet.

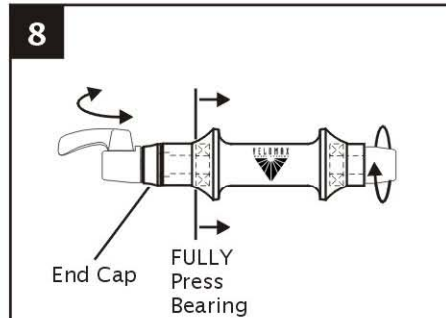

Remove the QR nut and place one of the End Caps against the BLACK Velomax Bearing Drift. Reinstall the QR nut and press the Bearing the rest of the way in. Remove QR and Bearing Drifts.

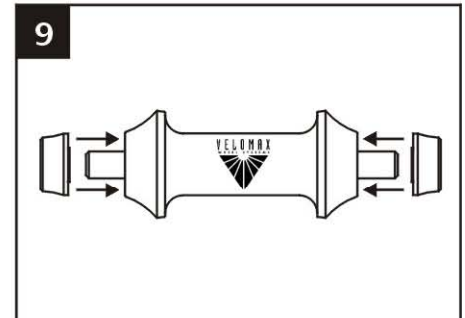

Wipe clean any excess Loctite. Slide both End Caps on by hand.

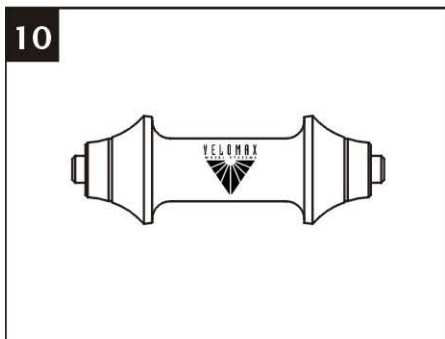

Completed Circuit Front Hub.

To make sure everything was done right, check the following:

1. Push on one side of the Axle. Then, push on the other. There should be no play.
2. Clamp the wheel into the bicycle fork dropout. Spin the wheel with the QR open. As the wheel is spinning, tighten the QR. If the wheel slows down quickly, then the Bearings are installed wrong.